



## 22.08 KW Type2 Wall Mounted Charging Stations EV Charger Wallbox Electric Vehicle Charging Station

Our Product Introduction

for more products please visit us on [evstationcharger.com](http://evstationcharger.com)

### Basic Information

- Place of Origin: China
- Brand Name: MINKO
- Certification: CE, ROHS
- Model Number: Wallbox-M22
- Minimum Order Quantity: 5 pieces
- Price: negotiation
- Packaging Details: L210xW85xH52 (mm)
- Delivery Time: 8 -10 working days
- Payment Terms: T/T, Western Union, MoneyGram, Paypal, Skrill, Transferwise
- Supply Ability: 1000000 pieces per month



### Product Specification

- Charging Plug: Type 2(Mennekes)
- Withstand Voltage: 3000v
- Input / Output Current: 8,12,16,20,24,28,32A Adjustable
- Max Output Power: 22.08 KW
- Output Cable: 5M
- Work Altitude: <2000M
- Stand By: <3W
- IP Level: IP65
- Highlight: 22kw ev wallbox charger, ip65 wall mounted ev charger, type2 wall mounted ev charger



### More Images



## Product Description

### 22.08 KW Type2 Wall-mounted Charging Stations EV charger Wallbox Electric Vehicle Charging Station

#### Description of Type2 Wallbox EV Charger

This product is mainly composed of charging station host, charging gun, wire, installation backplane, installation ingredients package, etc. It is a household electric vehicle charging equipment. The AC charging station is connected to the mains, the electric vehicle will be safely and reliably charged by the charging gun interface; to avoid affecting the product performance, should no acid and alkali and other corrosive gases in the surrounding; try to avoid direct rain or use in environments with high humidity, and should try to prevent damage from impacting the housing.

#### Product parameter description:

Model	M7	M11	M22
Input / Output Voltage	AC 230V / Single Phase	AC 400V / Three Phase	AC 400V / Three Phase
Input / Output Current	8,12,16,20,24,28,32 adjustable	8,10,12,14,16A adjustable	8,12,16,20,24,28,32A adjustable
Max Output Power	7.36 KW	11.04 KW	22.08 KW
Frequency	50/60Hz		
Input Cable	1M, hard-wired		
Charging Plug	Type 2(Mennekes)		
Output Cable	5M		
Withstand Voltage	3000V		
Work Altitude	<2000M		
Stand by	<3W		
Protection	over voltage protection, over load protection, over-temp protection, under voltage protection, earth leakage protection, lightning protection, short circuit protection		
IP level	IP65		
Touch Button	No		
LCD Screen	No		
Current Adjustment	Yes		
Bluetooth APP Charging	Yes / No		
WiFi APP charging	Yes / No		
RFID	Yes		
Timing / Appointment	Yes / No		
Certification	CE, RoHS		

#### Function introduction of Type2 Wallbox EV Charger

##### 1.Residual current detection (RCD)

Ac leakage protection automatically detects the AC mismatch between the power supply wires, which indicates that the current flows through the grounded (PE) wire. Ac residual current fault protection will trip when the current is 30 Ma.

##### 2.Surge protector

In: 3kA, Imax:6kA

##### 3.Leakage protection

When the leakage protection is started, it needs to be cut off the power outage and restart.

##### 4.Overcurrent protection

When the current exceeds the early warning value, the charging pile cuts off the power output, restarts automatically after 10 seconds, and does not recover automatically after 3 cycles until you cut of the power and restart.

##### 5.Overtvoltage protection

The protection starts when the voltage exceeds 275V, and automatically recovers when the voltage is restored and stabilized.

##### 6.Undervoltage protection

Start the protection when the voltage is less than 100V, and restore automatically when the voltage is restored and stabilized.

##### 7.Overttemperature protection

Start the protection when the internal temperature of the EV charging station exceeds 85 °C.

#### Installation Procedure:

1. Please use a percussion drill to drill holes according to the cardboard positioning
2. Install expansion bolts(6\*M6\*60MM)
3. fix the Mounting backplane with self-tapping screws(6\*M5\*50mm)
4. Align the main unit with the buckle on the back panel and install it, and then use screw to fix(4\*M5\*40)

#### Instructions

1. When the machine is on standby normally, the indicator light is fixed blue.
2. Remove the charging gun from the holder, insert the charging gun into the car charging socket.
3. After the gun insertion completed, the vehicle automatically starts to charge normally, and the blue meteor light on.
4. The indicator light always turns blue after the charge is completed.

# COMPONENT FEATURES



**LED Charging Indicator**  
Beautiful Blue meteor light

**LED Indicator function icon**  
Charging status display

**RFID sensing area**  
Swipe the card to start  
charging and stop

**Quick Mounting backplane**  
Simple and convenient  
installation method



**EV Charging Plug**  
Self-cleaning pins  
Temperature monitoring



**TPU Cable**  
Long service life  
Environment-friendly



**wall End Wire**

## FUNCTION & PROTECTION



Over  
Temperature  
Protection



Type B  
Leakage  
Protection



Waterproof  
& Dustproof  
IP65



Ground  
Protection



Over  
Voltage  
Protection



Over  
Current  
Protection



Short  
Circuit  
Protection



Lightning  
Protection





RFID

Plug and play-swiping the card to start charging more convenient and faster.

## PRODUCT SIZE

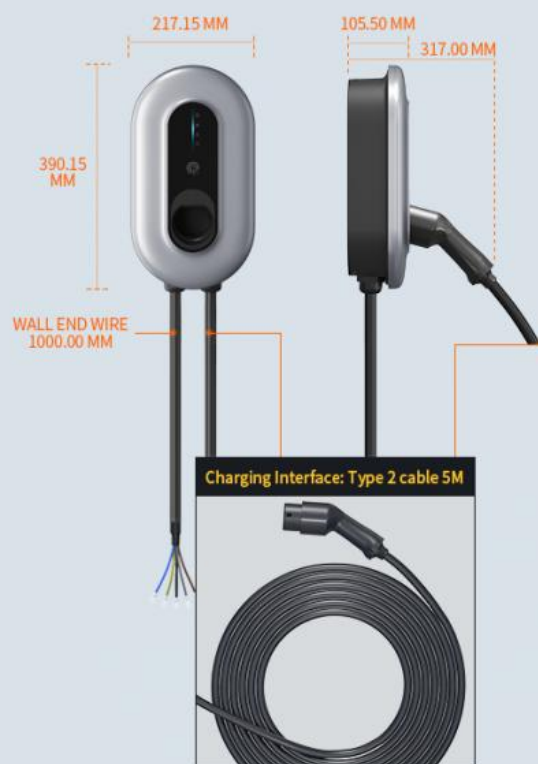

MINKO (SZ) TECHNOLOGY CO., LIMITED



+8613539872669



yumiko@szminko.com



evstationcharger.com

309 West Lake Industrial Zone, Cuishan Road, Dongxiao Street, Luohu District, SZ